



FlexFit™ RGBW

Installation Instructions

⚠ SAFETY PRECAUTIONS

Do not exceed the maximum wattage of the power supply.

Do not fold, crease, twist, or bend LED panels at sharp angles.

Do not cut FlexFit RGBW diagonally as it will result in voiding the warranty and performance issues.

Remove from power source immediately if any damage is found in the LED panel or cabling.

Cable Handling: The first 1.0" (25mm) of the leader cable should maintain its natural state before any bending occurs.

FlexFit is not walk-over rated.

Ensure all electrical connections are secure before applying power.

To prevent damage and ensure safety, avoid powering on the panels while removing the adhesive backing or during installation.

Refer to FlexFit RGBW Spec Sheet to ensure multiple connected panels are suitable for power supply.

Flexfit panels should be cut using a sharp knife or scissors as using a dull tool may lead to the panel shorting when powered.

Only cut along dotted lines. Failure to do so could damage the panel and void the warranty.

- 1 | Prepare mounting surface by removing any dirt, debris, or moisture.

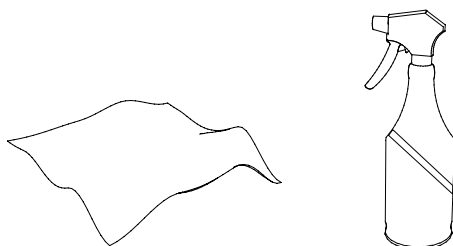

- 2 | Arrange panels on the surface to determine optimal placement. Power and connect panels together to ensure all panels are functioning properly.

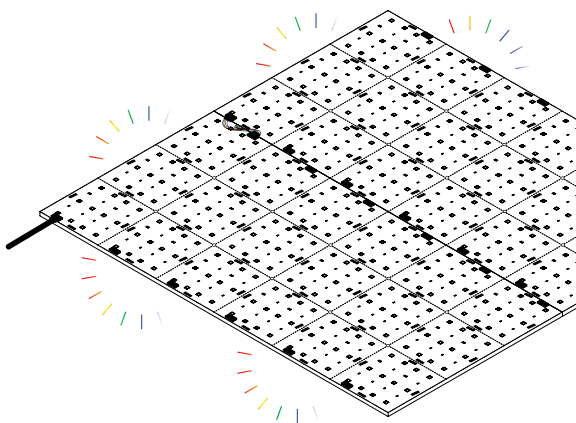

JUMPER CABLES

Each 12" x 24" panel includes two 3" 5-wire jumper cables.

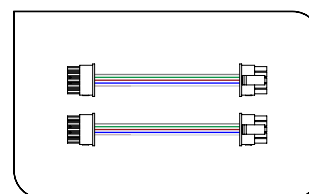

ORIENTATION

Ensure that the end with the power feed is positioned towards the power source, and that diodes all face the same direction to ensure color consistency.

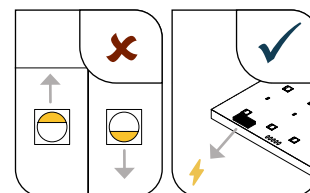



FlexFit™ RGBW

Installation Instructions

- 3** Disconnect jumper and power cables. Mark where panels are to be cut and trimmed. Ensure that there is a minimum of two jumpers that can be connected between each panel.

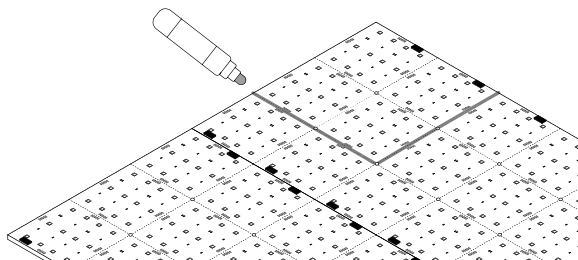

PANELS W/O CONNECTORS
If panel shape requires the removal of connectors, a minimum of two positive and negative jumpers must be soldered from one sheet to the next sheet prior to installation.

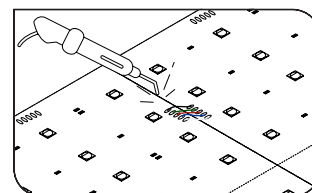

- 4** Using a sharp cutting tool, trim panels exactly on the dotted line.

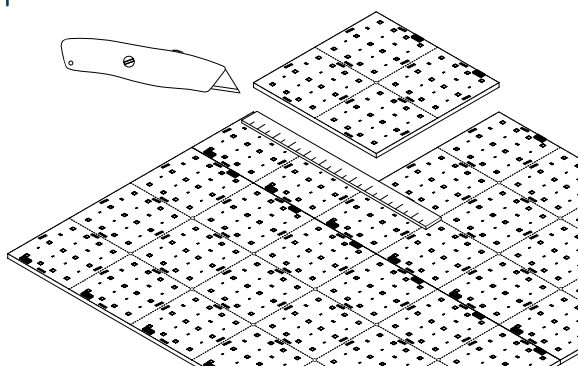

CUTTING
For best results when cutting panels, make sure each cut is one single motion that starts and ends at a mounting hole. Any crimping in the PCB from an inconsistent cut can lead to issues in performance.

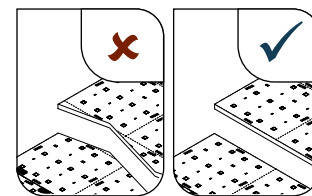

DO NOT CUT DIAGONALLY
Cutting diagonally will result in voiding the warranty and cause performance issues.

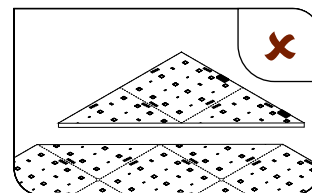

- 5** Peel off 3M adhesive protective film. Optional Mounting: Use screw holes

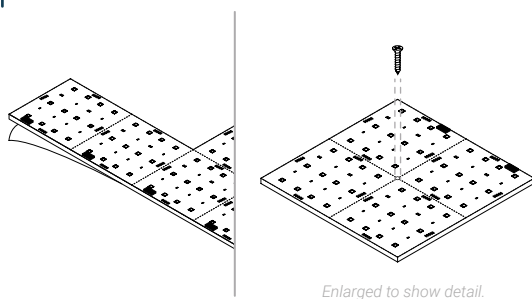

ORIENTATION
Ensure that the end with the power feed is positioned towards the power source, and that diodes all face the same direction to ensure color consistency.

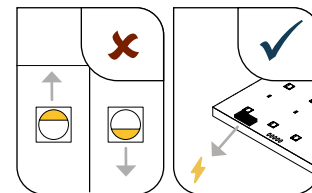

PROFILE SECURING
Refrain from using screws larger than 1.8mm and utilize washers to avoid circuit interruption. Ensure screws are driven vertically and do not cut into the FlexFit panel to avoid shorting the panel.

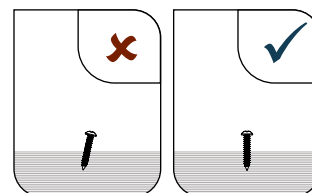



FlexFit™ RGBW

Installation Instructions

- 6 | Begin by placing the first sheet in far corner of the workspace. Peel off the adhesive backing from one side, secure it, and then gradually remove the protective film while applying the rest of the sheet.

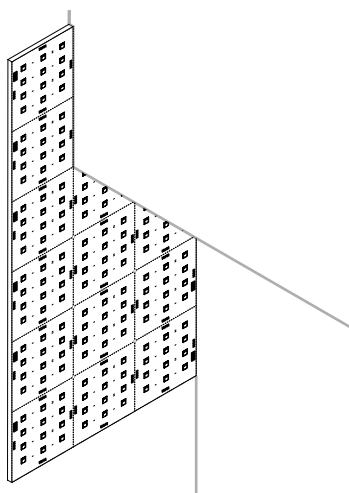

SECURING PANELS
Using your hands, apply gentle pressure along the entire panel to eliminate any air pockets and ensure it is securely in place.

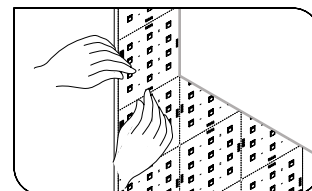

- 7 | After adhering the first sheet, align the edges of the subsequent sheet with those of the previous one, then carefully lay it down. Press the panels firmly by hand and smooth out any air pockets for a secure fit.

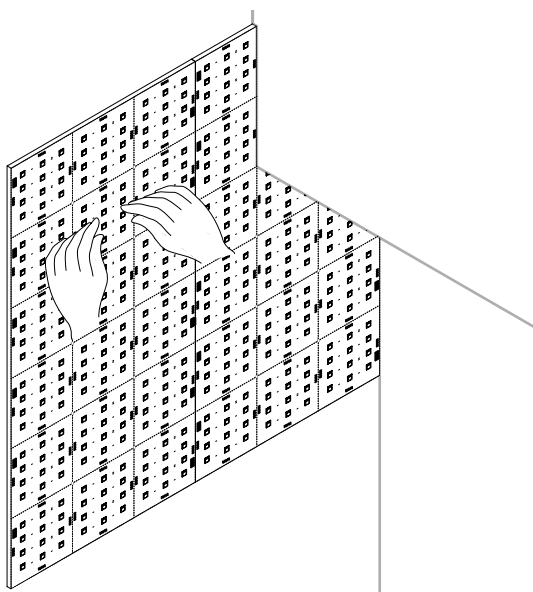

FlexFit™ RGBW

Installation Instructions

- 8 | Once all panels are installed, begin by connecting all the panels together using the included jumper cables. Power on.

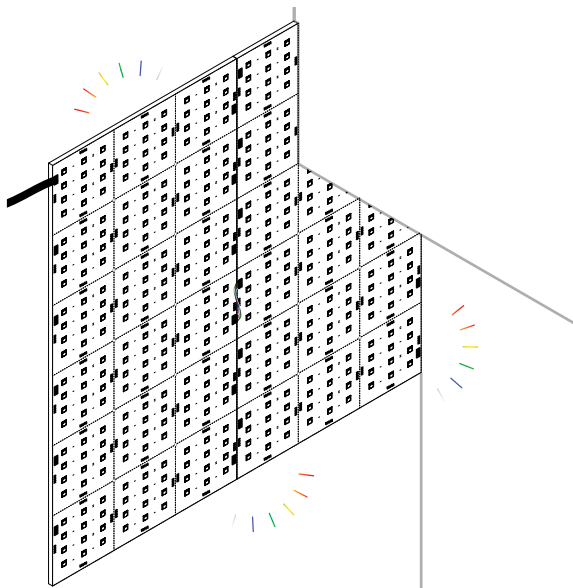

- 9 | Bend the wires around the LEDs and secure them to the PCB with silicone rubber adhesive to prevent obstruction of the LEDs and the creation of dark spots.

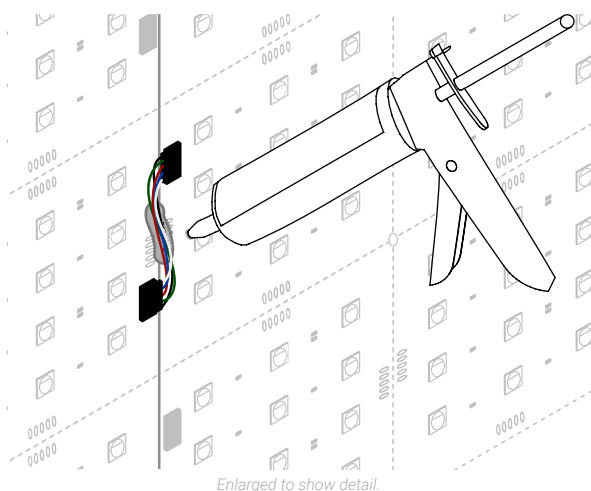

OFFSET SURFACE
For best diffusing results, offset diffusing surface from LED panel by at least 1.5x the largest gap between diodes (center to center).

